

NOTE:  
1. ALL FINISHED FLOOR ELEVATIONS SHALL BE SET A MINIMUM OF 16 INCHES ABOVE THE CENTERLINE OF THE ADJACENT ROADWAY.  
2. ALL FINISHED FLOOR ELEVATIONS ARE A MINIMUM OF 1 FOOT ABOVE THE LIMITS OF THE 100 YEAR FLOOD PLAIN AND/OR 1 FOOT ABOVE THE 100-YEAR DESIGN HIGH WATER LEVEL OF THE ADJACENT DETENTION/RETENTION AREA.  
3. IN CASES WHERE THE ABOVE CONDITIONS CONFLICT, NOTE #2 SHALL TAKE PRECEDENCE.  
4. SIDE YARD SWALE SHALL BE CENTERED ON THE COMMON PROPERTY LINE.

**TYPICAL LOT GRADING**  
NOT TO SCALE

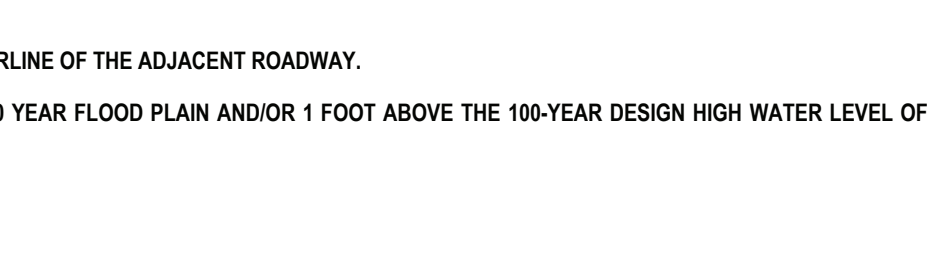
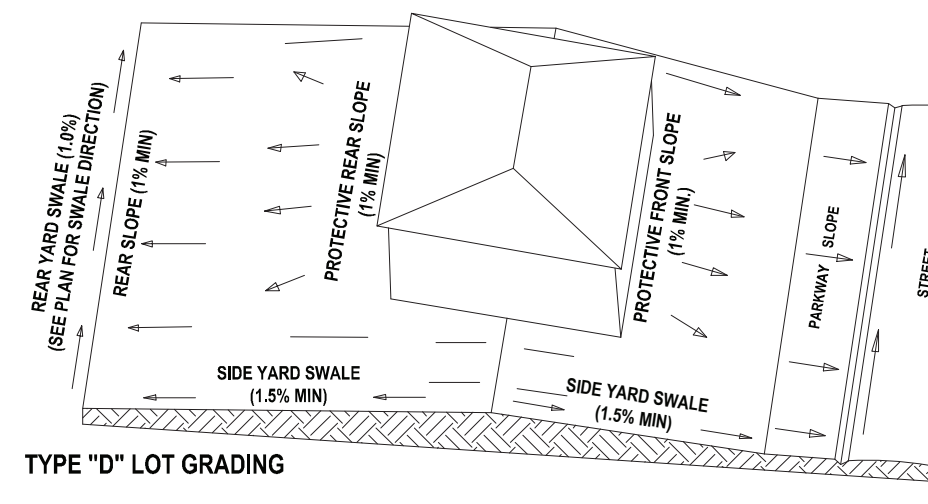
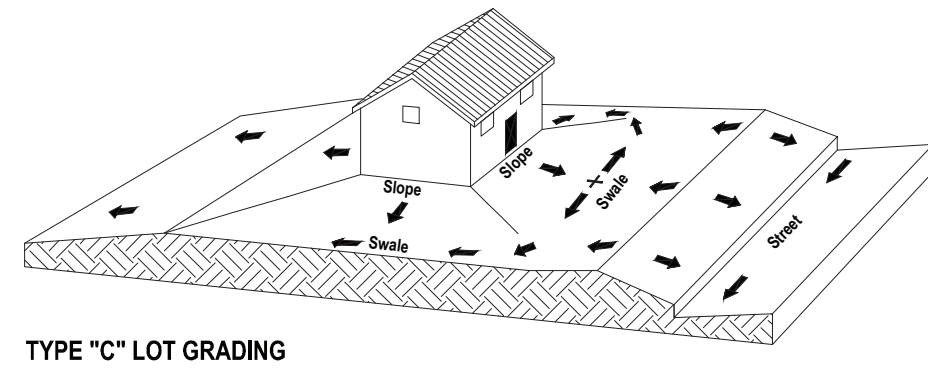

NOTE:  
1. ALL FINISHED FLOOR ELEVATIONS SHALL BE SET A MINIMUM OF 16 INCHES ABOVE THE CENTERLINE OF THE ADJACENT ROADWAY.  
2. ALL FINISHED FLOOR ELEVATIONS ARE A MINIMUM OF 1 FOOT ABOVE THE LIMITS OF THE 100 YEAR FLOOD PLAIN AND/OR 1 FOOT ABOVE THE 100-YEAR DESIGN HIGH WATER LEVEL OF THE ADJACENT DETENTION/RETENTION AREA.  
3. IN CASES WHERE THE ABOVE CONDITIONS CONFLICT, NOTE #2 SHALL TAKE PRECEDENCE.  
4. SIDE YARD SWALE SHALL BE CENTERED ON THE COMMON PROPERTY LINE.

**TYPICAL LOT GRADING**  
NOT TO SCALE

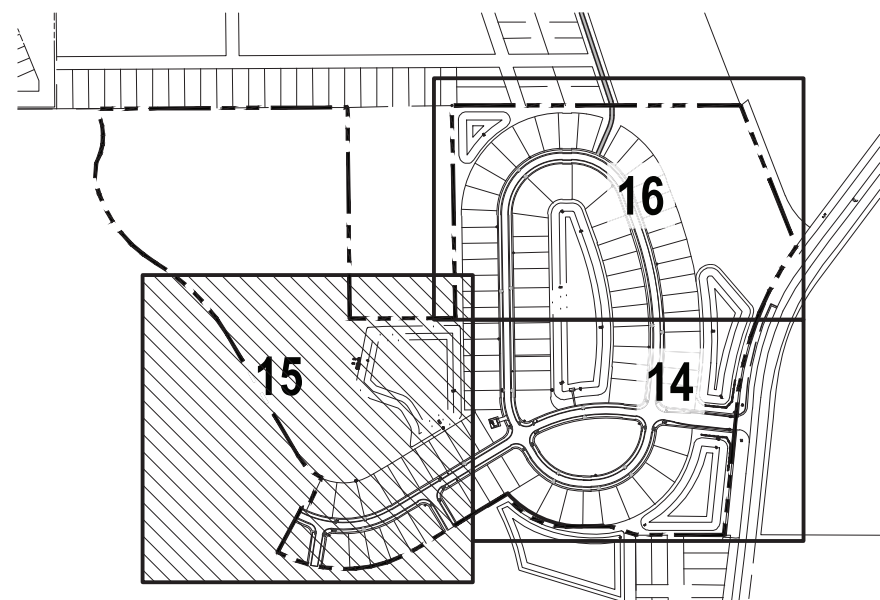

**KEY MAP**  
NOT TO SCALE

### GRADING LEGEND

- 72.0 EXISTING SPOT ELEVATION
- PROPOSED SPOT ELEVATION
- EXISTING CONTOUR
- PROPOSED CONTOUR
- DRAINAGE FLOW ARROW

### BENCHMARK INFORMATION:

- #1 5/8" IR ELEVATION = 16.19
- #2 1/2" IRC LS 3913 ELEVATION = 16.48
- #3 1 1/2" IP ELEVATION = 15.90

VERTICAL DATA  
ELEVATIONS SHOWN HEREON ARE BASED ON NATIONAL GEODETIC SURVEY VERTICAL CONTROL, ORDER - SECOND, CLASS 1 CONTROL POINT AK7016, NORTH AMERICAN VERTICAL DATUM, 1988 ADJUSTMENT (NAVD '88).

### REVISIONS

DATE	DESCRIPTION
7/11/19	PER CITY COMMENTS
9/9/19	PER CITY COMMENTS

1230 North US1, Suite 3  
Ormond Beach, Florida 32174  
Phone (385) 872-7794  
www.newkirk-engineering.com  
C.A. # 30209  
L.C. # 26000584  
© 2013  
Civil Engineering,  
Transportation, CEI &  
Landscape Architecture



### GRADING PLAN (SHT. 2 OF 3) EDGEWATER PRESERVE, PHASE 1 VOLCO ROAD EDGEWATER, FL 32141

THIS DRAWING IS THE PROPERTY OF NEWKIRK ENGINEERING. ANY USE OR REPRODUCTION IN WHOLE OR PART IS PROHIBITED WITHOUT THE EXPRESSED WRITTEN CONSENT OF NEWKIRK ENGINEERING. COPYRIGHT 2013 ALL RIGHTS RESERVED.



HARRY H. NEWKIRK, P.E. # 62971

PROJECT No: 2018-137  
DATE: APRIL 2019  
DESIGN BY: HHN  
DRAWN BY: NWS  
CHECKED BY: HHN  
SCALE: 1" = 40'

DRAWING NUMBER

15

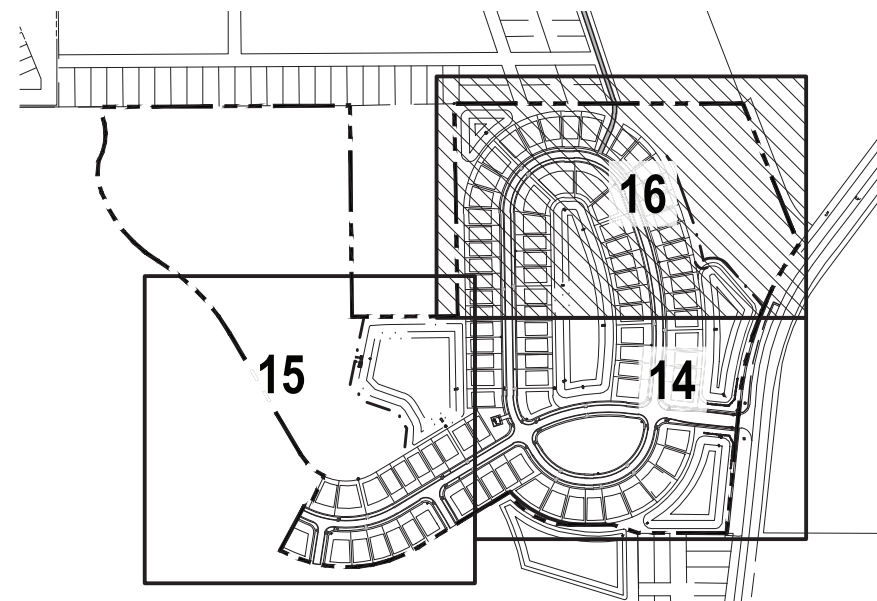
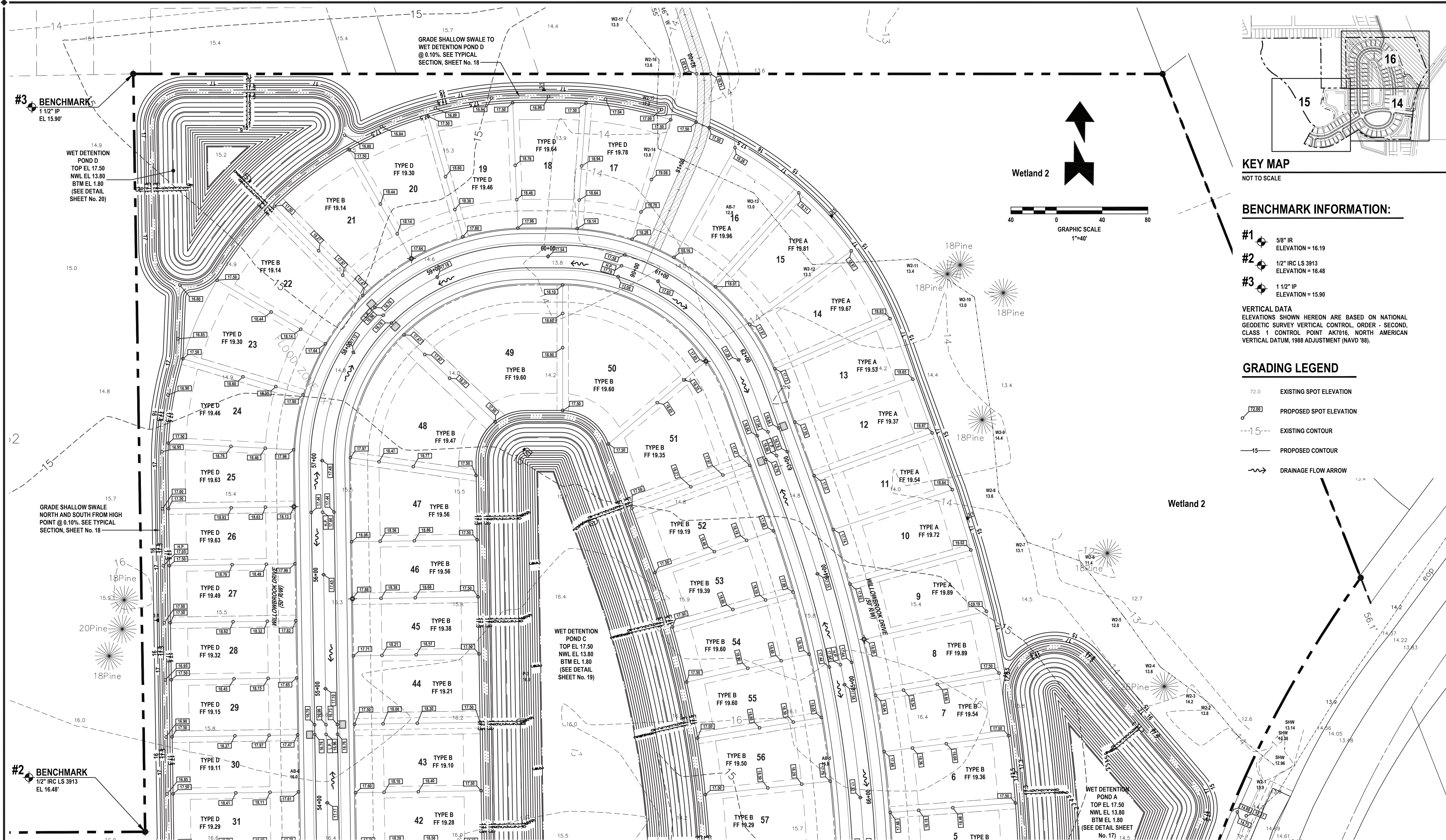

KEY MAP  
NOT TO SCALE

BENCHMARK INFORMATION:

- #1 5/8" IR ELEVATION = 16.19
- #2 1/2" IRC LS 3913 ELEVATION = 16.48
- #3 1 1/2" IP ELEVATION = 15.90

VERTICAL DATA  
ELEVATIONS SHOWN HEREON ARE BASED ON NATIONAL  
GEODETIC SURVEY VERTICAL CONTROL - ORDER - SECOND,  
CLASS 1 CONTROL. POINT AK7016, NORTH AMERICAN  
VERTICAL DATUM, 1988 ADJUSTMENT (NAVD '88).

GRADING LEGEND

- EXISTING SPOT ELEVATION
- PROPOSED SPOT ELEVATION
- EXISTING CONTOUR
- PROPOSED CONTOUR
- DRAINAGE FLOW ARROW

- NOTE:
- ALL FINISHED FLOOR ELEVATIONS SHALL BE SET A MINIMUM OF 16 INCHES ABOVE THE CENTERLINE OF THE ADJACENT ROADWAY.
  - ALL FINISHED FLOOR ELEVATIONS ARE A MINIMUM OF 1 FOOT ABOVE THE LIMITS OF THE 100 YEAR FLOOD PLAIN AND/OR 1 FOOT ABOVE THE 100-YEAR DESIGN HIGH WATER LEVEL OF THE ADJACENT DETENTION/RETENTION AREA.
  - IN CASES WHERE THE ABOVE CONDITIONS CONFLICT, NOTE #2 SHALL TAKE PRECEDENCE.
  - SIDE YARD SWALE SHALL BE CENTERED ON THE COMMON PROPERTY LINE.

TYPICAL LOT GRADING

NOT TO SCALE

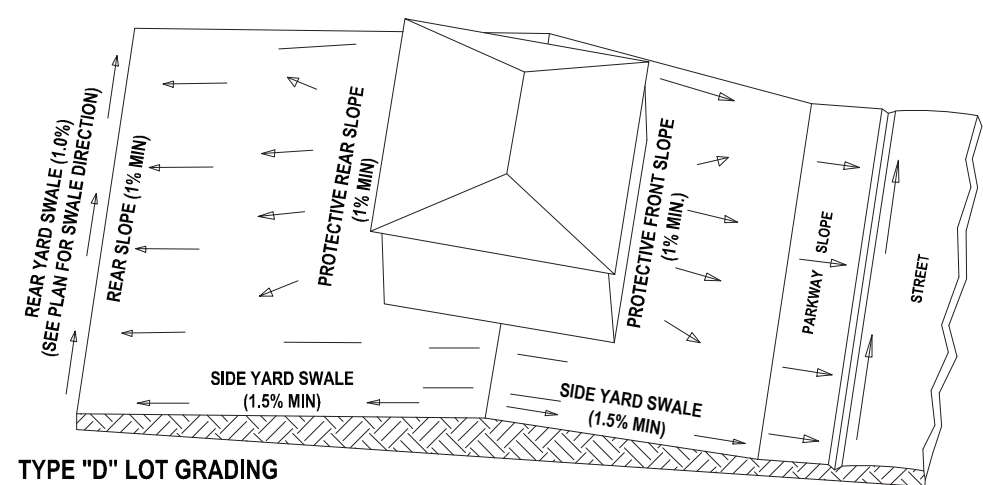
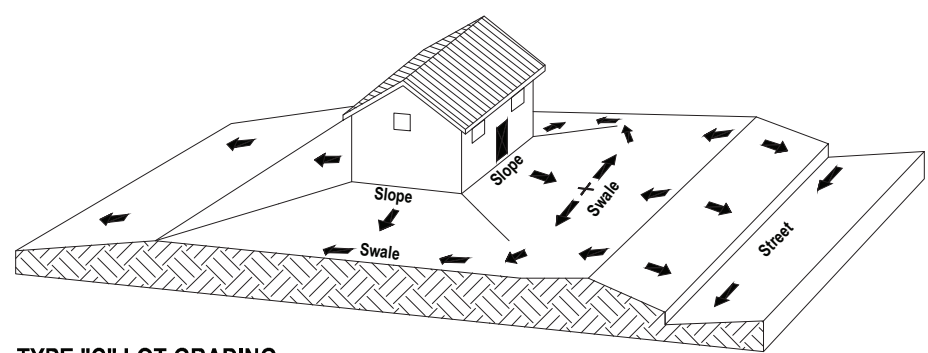
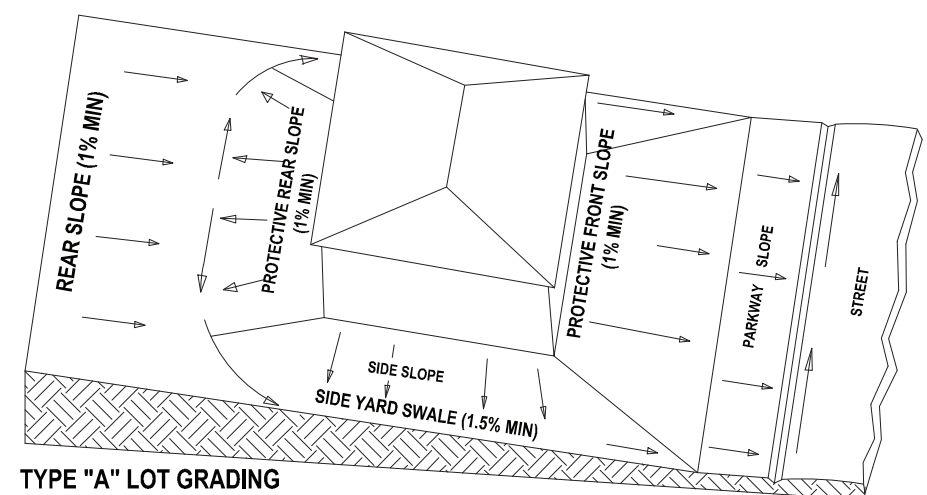
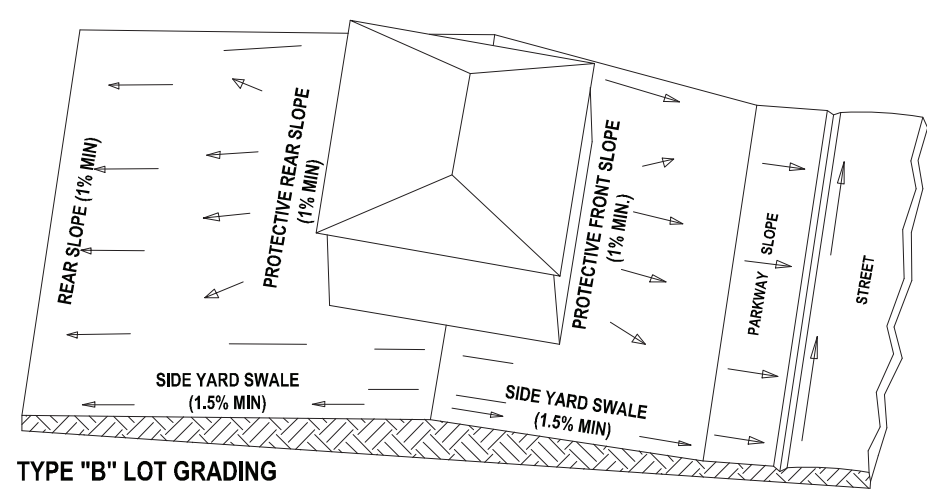

**WARNING !!**  
CONTRACTOR SHALL TAKE ALL PRECAUTIONS DURING  
CONSTRUCTION TO AVOID CONTACT WITH EXISTING  
UNDERGROUND UTILITIES, GAS MAINS AND OVERHEAD  
ELECTRIC IN THE RIGHT-OF-WAY.

REVISIONS

DATE	DESCRIPTION
7/11/19	PER CITY COMMENTS
9/9/19	PER CITY COMMENTS

1230 North US1, Suite 3  
Ormond Beach, Florida 32174  
Phone (386) 872-7794  
www.newkirk-engineering.com  
C.A. # 30209  
L.C. # 26000584  
© 2013  
Civil Engineering,  
Transportation, CEI &  
Landscape Architecture

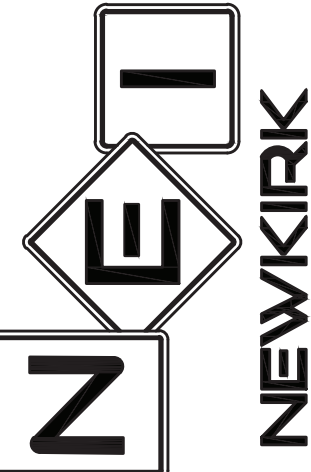

GRADING PLAN (SHT. 3 OF 3)  
EDGEWATER PRESERVE, PHASE 1  
VOLCO ROAD  
EDGEWATER, FL 32141

THIS DRAWING IS THE PROPERTY OF NEWKIRK  
ENGINEERING. ANY USE OR REPRODUCTION IN  
WHOLE OR PART IS PROHIBITED WITHOUT THE  
EXPRESSED WRITTEN CONSENT OF NEWKIRK  
ENGINEERING. COPYRIGHT 2013 ALL RIGHTS  
RESERVED.

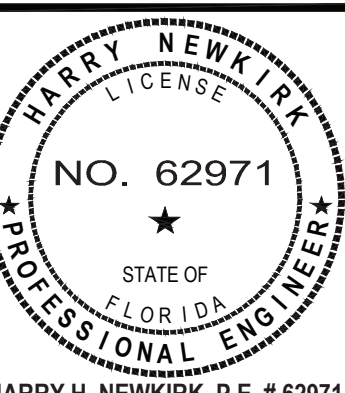

HARRY H. NEWKIRK, P.E. # 62971

PROJECT No: 2018-137  
DATE: APRIL 2019  
DESIGN BY: HHN  
DRAWN BY: NWS  
CHECKED BY: HHN  
SCALE: 1" = 40'  
DRAWING NUMBER